

ITEM #	PART NUMBER	CONFIGURATION	REV	DESCRIPTION	MATERIAL	QTY
1	PT-2053-01	X33P	A	16.475in. D Perforated Shelf	14GA STEEL(0.0747)	2

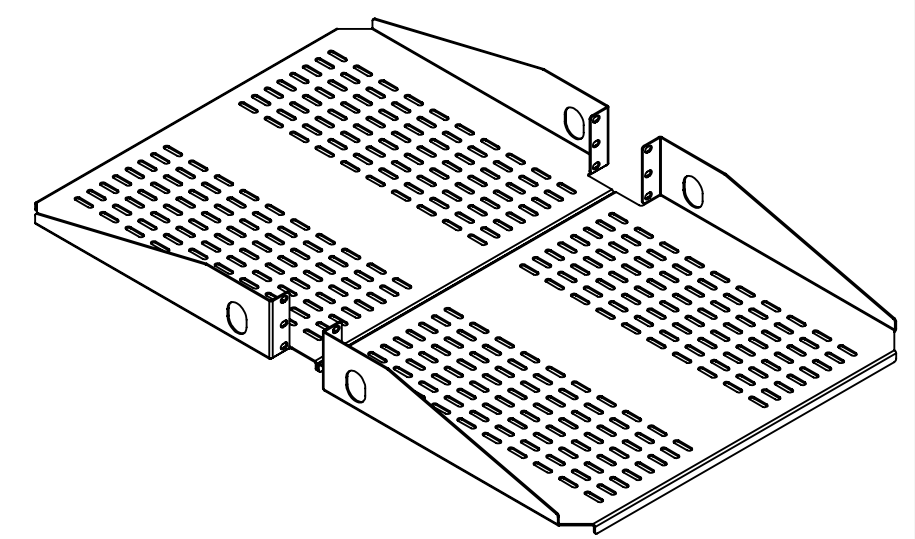
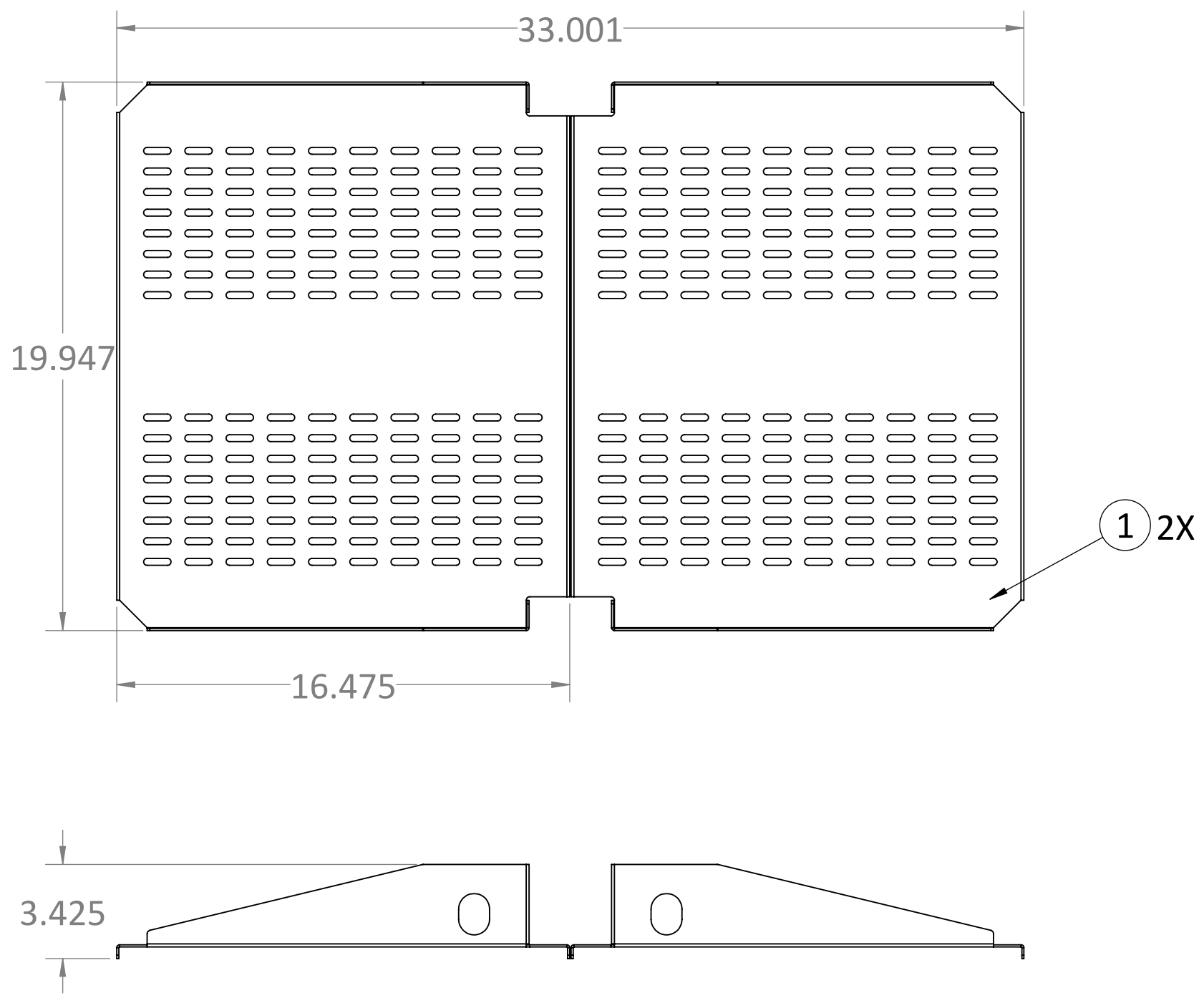

RXL
 PROPRIETARY AND CONFIDENTIAL:
 THE INFORMATION CONTAINED IN THIS
 DRAWING IS THE SOLE PROPERTY OF RXL.
 ANY REPRODUCTION IN PART OR AS A
 WHOLE WITHOUT THE WRITTEN
 PERMISSION OF RXL IS PROHIBITED.

SERIES/FAMILY NUMBER:
RXL-2053

DESCRIPTION:
RXL-2053 Dual Sided Shelf

REVISION	DATE	REVISION DESCRIPTION:
A	11/25/2019	Initial

CONFIGURATION (SEE TABLE DETAILS/"X" DENOTES COLOR):
X33P

COMMENTS/FOLDER PATH:
 B:\RXL Inc\RXL Engineering - General\RXL\Section 2 - Open Racks\RXL-2053 Dual Sided 2Post Rack Shelf\

UNLESS OTHERWISE SPECIFIED:		MATERIAL:		FULL PART NUMBER:	
DIMENSIONS ARE IN INCHES		14GA STEEL(0.0747)		RXL-2053-X33P	
TOLERANCES: ±0.03		FINISH:		DRAWN BY: Jackson Chong	
FRACTIONAL: ±1/32		PAINT		DRAWN DATE: 11/25/2019	
ANGULAR: ±1°		WEIGHT:		DO NOT SCALE DRAWING	
TWO PLACE DECIMAL ±0.03		15.07lbs.		Scale: 1:4	
THREE PLACE DECIMAL ±0.030		SURFACE AREA:		DRAWING SIZE: B	
		1501.13in. ²		SHEET 1 OF 3	

ITEM #	PART NUMBER	CONFIGURATION	REV	DESCRIPTION	MATERIAL	QTY
1	PT-2053-01	X19P	A	9.475in. D Perforated Shelf	14GA STEEL(0.0747)	2

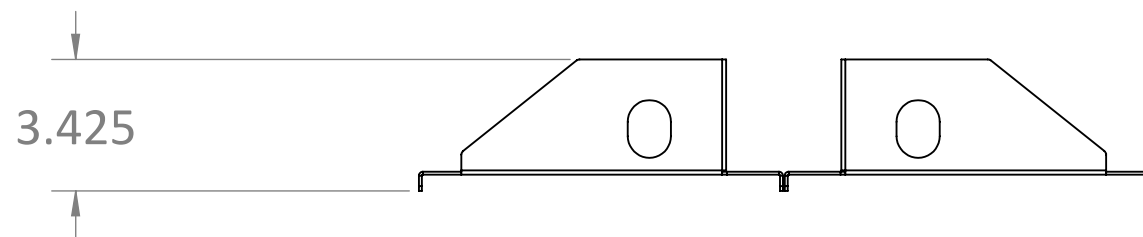
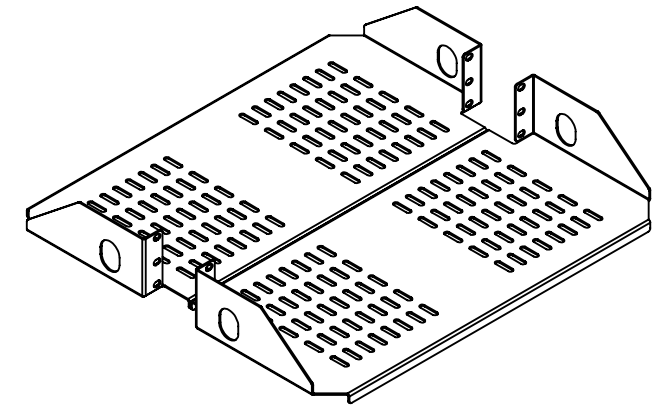
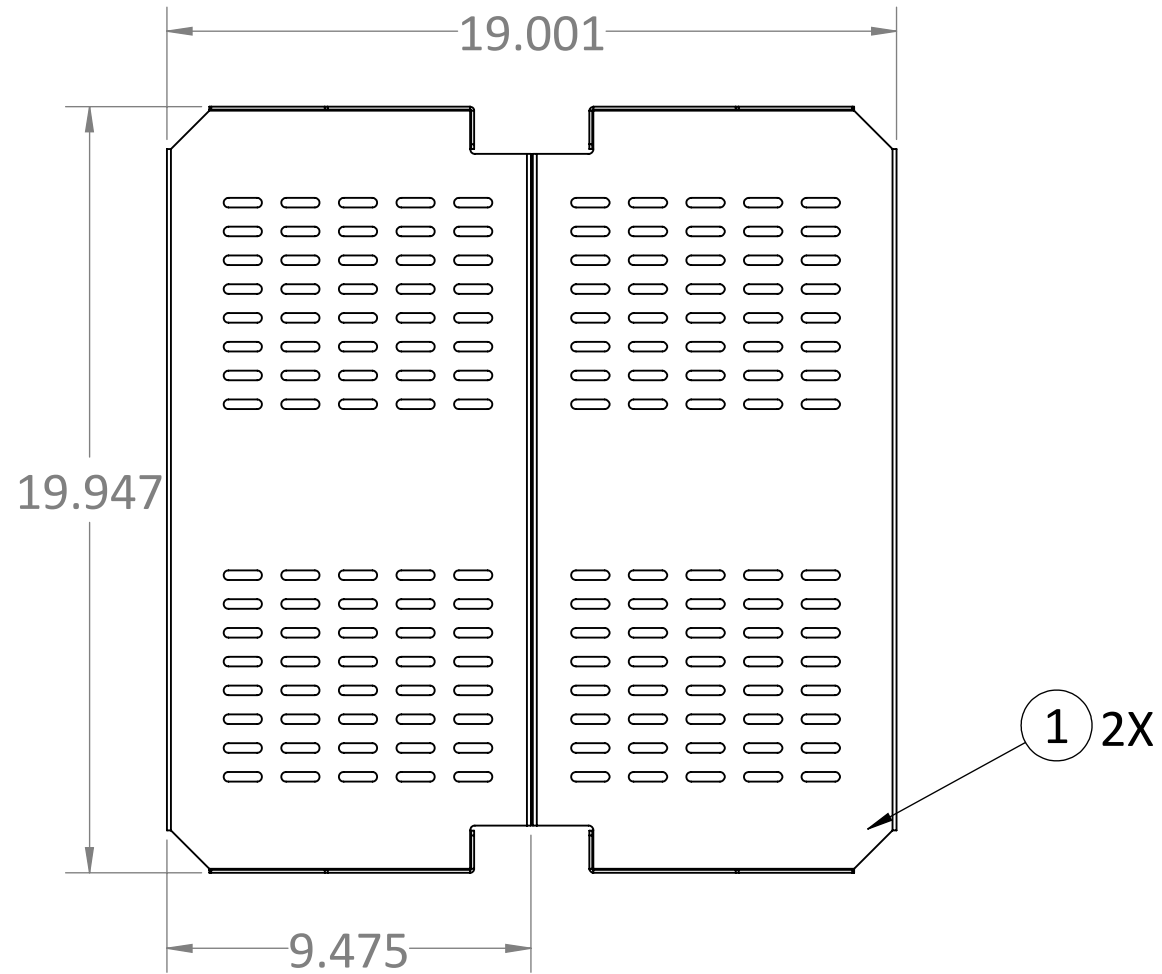

PROPRIETARY AND CONFIDENTIAL:
THE INFORMATION CONTAINED IN THIS
DRAWING IS THE SOLE PROPERTY OF RXL.
ANY REPRODUCTION IN PART OR AS A
WHOLE WITHOUT THE WRITTEN
PERMISSION OF RXL IS PROHIBITED.

SERIES/FAMILY NUMBER:
RXL-2053

DESCRIPTION:
RXL-2053 Dual Sided Shelf

REVISION
A

DATE
11/25/2019

REVISION DESCRIPTION:
Initial

CONFIGURATION (SEE TABLE DETAILS/"X" DENOTES COLOR):
X19P

COMMENTS/FOLDER PATH:
B:\RXL Inc\RXL Engineering - General\RXL\Section 2 - Open Racks\RXL-2053 Dual Sided 2Post Rack Shelf\

UNLESS OTHERWISE SPECIFIED:
DIMENSIONS ARE IN INCHES
TOLERANCES: ± 0.03
FRACTIONAL: $\pm 1/32$
ANGULAR: $\pm 1^\circ$
TWO PLACE DECIMAL ± 0.03
THREE PLACE DECIMAL ± 0.030

MATERIAL:
FINISH:
PAINT
WEIGHT:
8.99lbs.

SURFACE AREA:
894.79in.²

FULL PART NUMBER:
RXL-2053-X19P

DRAWN BY: Jackson Chong
DRAWN DATE: 11/25/2019

DO NOT SCALE DRAWING
Scale: 1:4
DRAWING SIZE: **B**
SHEET 2 OF 3

ITEM #	PART NUMBER	CONFIGURATION	REV	DESCRIPTION	MATERIAL	QTY
1	PT-2053-01	X19S	A	9.475in. D Solid Shelf	14GA STEEL(0.0747)	2

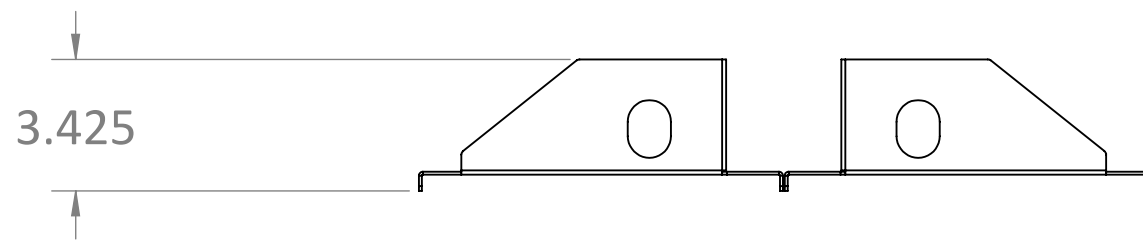
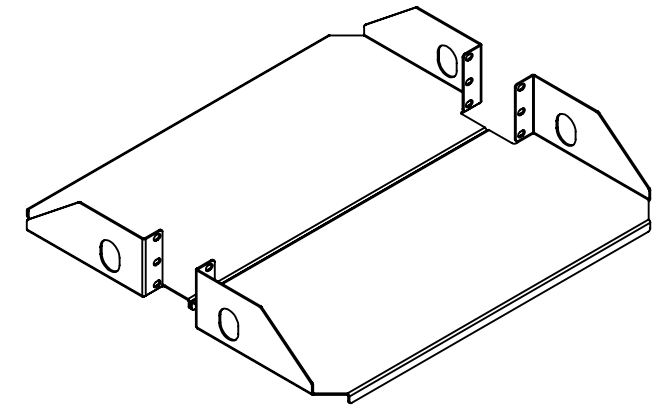
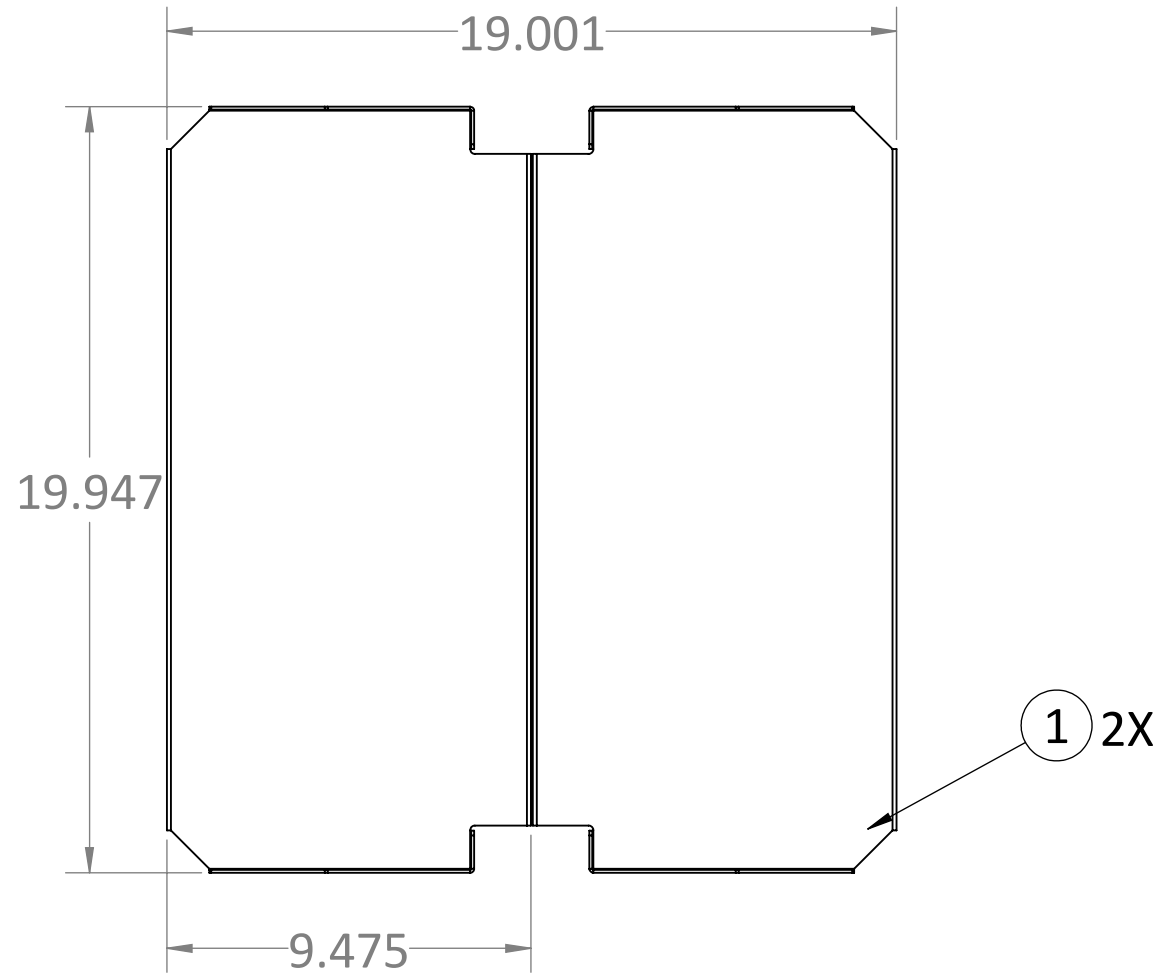

PROPRIETARY AND CONFIDENTIAL:
THE INFORMATION CONTAINED IN THIS
DRAWING IS THE SOLE PROPERTY OF RXL.
ANY REPRODUCTION IN PART OR AS A
WHOLE WITHOUT THE WRITTEN
PERMISSION OF RXL IS PROHIBITED.

SERIES/FAMILY NUMBER:
RXL-2053

DESCRIPTION:
RXL-2053 Dual Sided Shelf

REVISION
A

DATE
11/25/2019

REVISION DESCRIPTION:
Initial

CONFIGURATION (SEE TABLE DETAILS/"X" DENOTES COLOR):
X19S

COMMENTS/FOLDER PATH:
B:\RXL Inc\RXL Engineering - General\RXL\Section 2 - Open Racks\RXL-2053 Dual Sided 2Post Rack Shelf\

UNLESS OTHERWISE SPECIFIED:
DIMENSIONS ARE IN INCHES
TOLERANCES: ± 0.03
FRACTIONAL: $\pm 1/32$
ANGULAR: $\pm 1^\circ$
TWO PLACE DECIMAL ± 0.03
THREE PLACE DECIMAL ± 0.030

MATERIAL:
FINISH:
PAINT
WEIGHT:
9.79lbs.

SURFACE AREA:
943.18in.²

FULL PART NUMBER:
RXL-2053-X19S

DRAWN BY: Jackson Chong
DRAWN DATE: 11/25/2019

DO NOT SCALE DRAWING
Scale: 1:4
DRAWING SIZE: **B**
SHEET 3 OF 3

8

7

6

5

4

3

2

1

A

B

C

D

E

F