

ITEM #	PART NUMBER	CONFIGURATION	DESCRIPTION	MATERIAL	QTY
1	AS-1082-01	X112	Runway Offset Kit Hardware Assembly		2

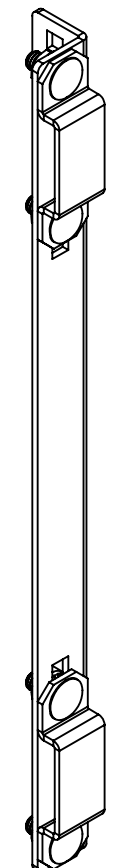
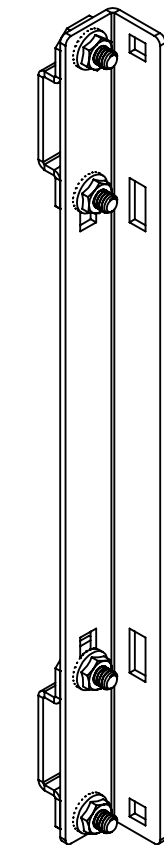
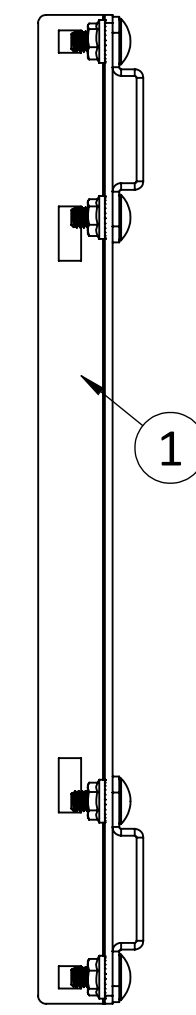
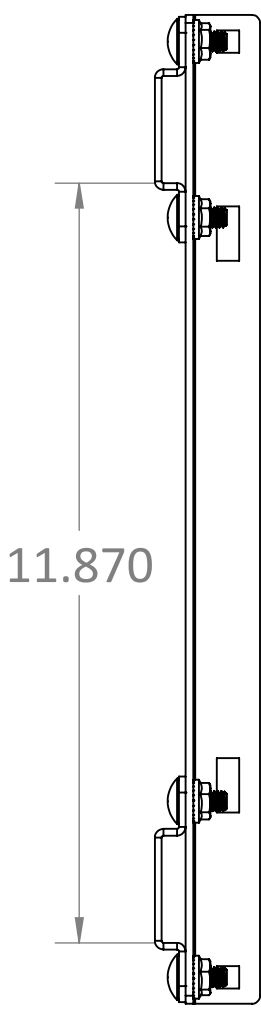
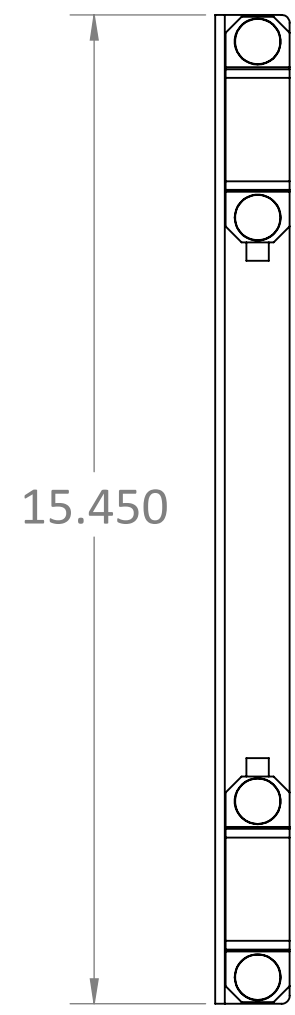

RXL
 PROPRIETARY AND CONFIDENTIAL:
 THE INFORMATION CONTAINED IN THIS
 DRAWING IS THE SOLE PROPERTY OF RXL.
 ANY REPRODUCTION IN PART OR AS A
 WHOLE WITHOUT THE WRITTEN
 PERMISSION OF RXL IS PROHIBITED.

SERIES/FAMILY NUMBER:
RXL-1082

DESCRIPTION:
RXL-1082 Runway Offset Kit

REVISION A	DATE 6/15/2020	REVISION DESCRIPTION: Initial
----------------------	--------------------------	----------------------------------

CONFIGURATION (SEE TABLE DETAILS/"X" DENOTES COLOR):
X112

COMMENTS/FOLDER PATH:
 B:\RXL Inc\RXL Engineering - General\RXL\Section 1 - Cable Pathways\RXL-1082 Runway Offset Kit\

UNLESS OTHERWISE SPECIFIED: DIMENSIONS ARE IN INCHES TOLERANCES: ±0.03 FRACTIONAL: ±1/32 ANGULAR: ±1° TWO PLACE DECIMAL ±0.03 THREE PLACE DECIMAL ±0.030	MATERIAL:	FULL PART NUMBER: RXL-1082-X112
	FINISH: PAINT	
	WEIGHT: 2.93lbs.	SURFACE AREA: 202.12in. ²

DRAWING SIZE: **B**
 SHEET 1 OF 1

8	7	6	5	4	3	2	1
---	---	---	---	---	---	---	---