

ITEM #	PART NUMBER	CONFIGURATION	DESCRIPTION	MATERIAL	QTY
1	PT-1019-01	X38	Ceiling Hat Bracket, For 3/8 Thread	10GA STEEL(0.1345)	1

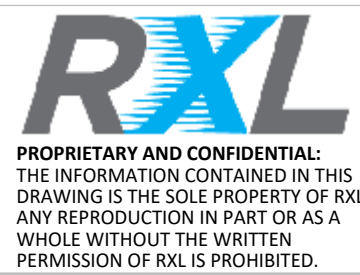
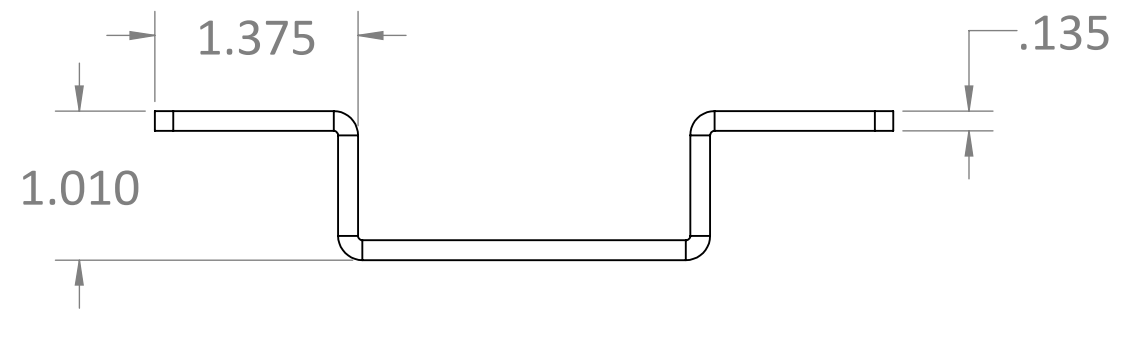
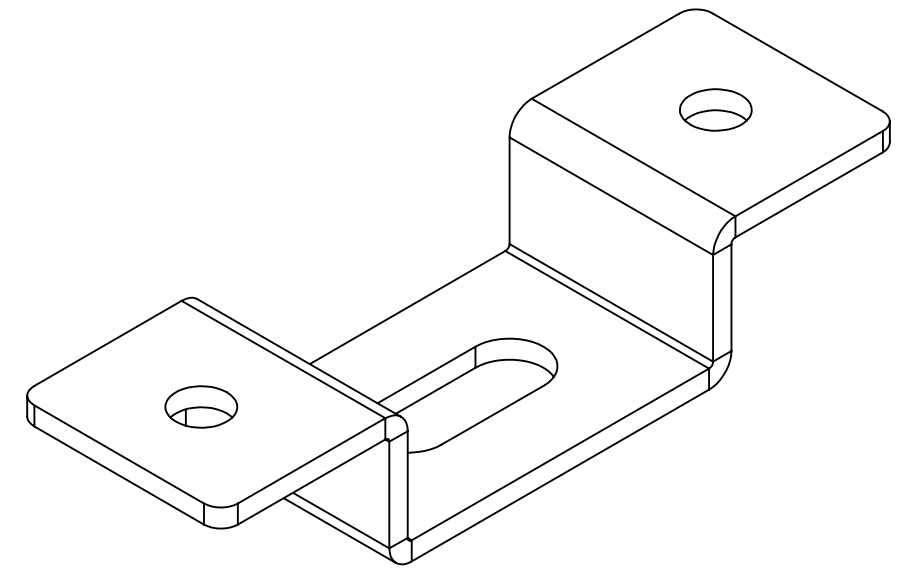
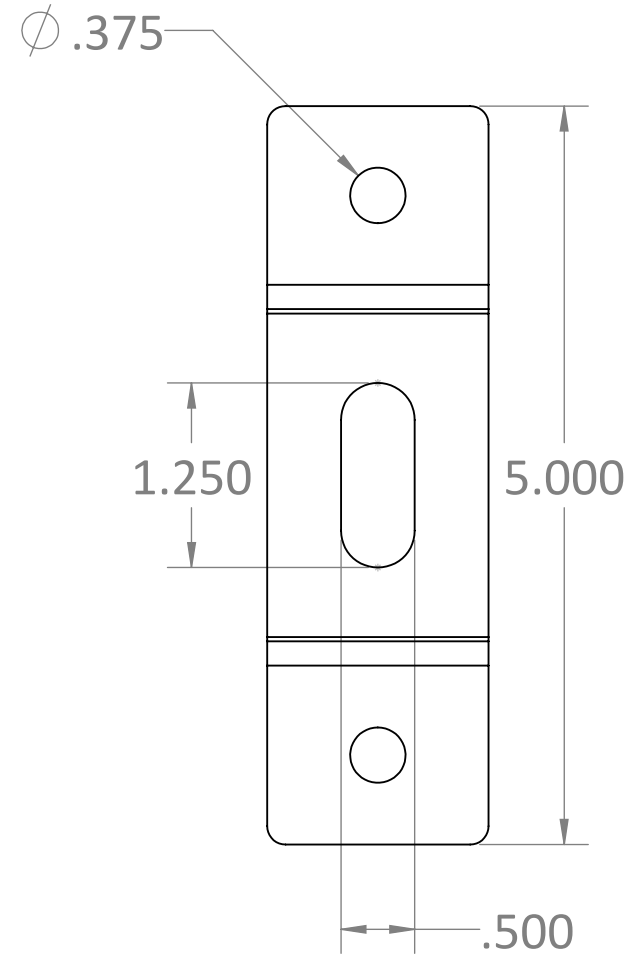

SERIES/FAMILY NUMBER: <b>RXL-1019</b>		CONFIGURATION (SEE TABLE DETAILS/"X" DENOTES COLOR): <b>X38</b>		COMMENTS/FOLDER PATH: B:\RXL Inc\RXL Engineering - General\RXL\Section 1 - Cable Pathways\RXL-1019 Ceiling Support Brackets\	
DESCRIPTION: <b>3/8in. Slot Ceiling Support Bracket</b>		UNLESS OTHERWISE SPECIFIED: DIMENSIONS ARE IN INCHES TOLERANCES: $\pm 0.03$ FRACTIONAL: $\pm 1/32$ ANGULAR: $\pm 1^\circ$ TWO PLACE DECIMAL $\pm 0.03$ THREE PLACE DECIMAL $\pm 0.030$		MATERIAL: <b>10GA STEEL(0.1345)</b>	FULL PART NUMBER: <b>RXL-1019-X38</b>
REVISION <b>A</b>	DATE <b>9/23/2020</b>	REVISION DESCRIPTION: <b>Initial</b>		FINISH: <b>PAINT</b>	DRAWN BY: Jackson Chong DRAWN DATE: 9/23/2020
				WEIGHT: <b>0.34lbs.</b>	SURFACE AREA: <b>21.01in.<sup>2</sup></b>
				DO NOT SCALE DRAWING Scale: 1:4	
				DRAWING SIZE: <b>B</b> SHEET 1 OF 3	

8	7	6	5	4	3	2	1
---	---	---	---	---	---	---	---

ITEM #	PART NUMBER	CONFIGURATION	DESCRIPTION	MATERIAL	QTY
1	PT-1019-01	X12	Ceiling Hat Bracket, For 1/2 Thread	10GA STEEL(0.1345)	1

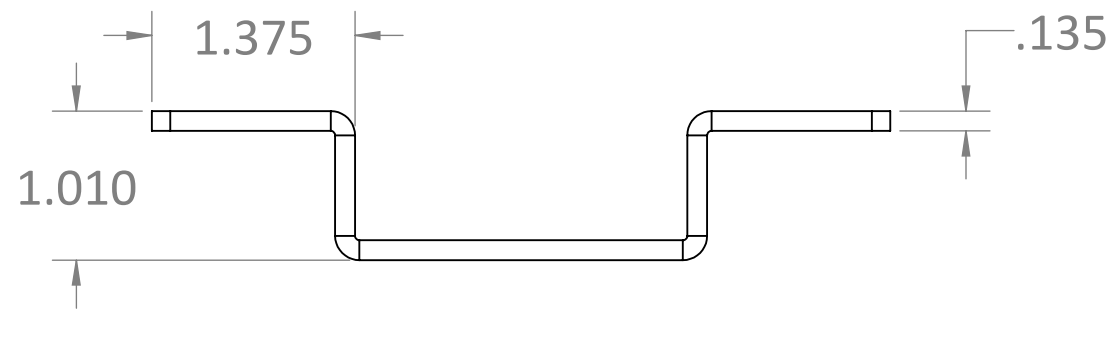
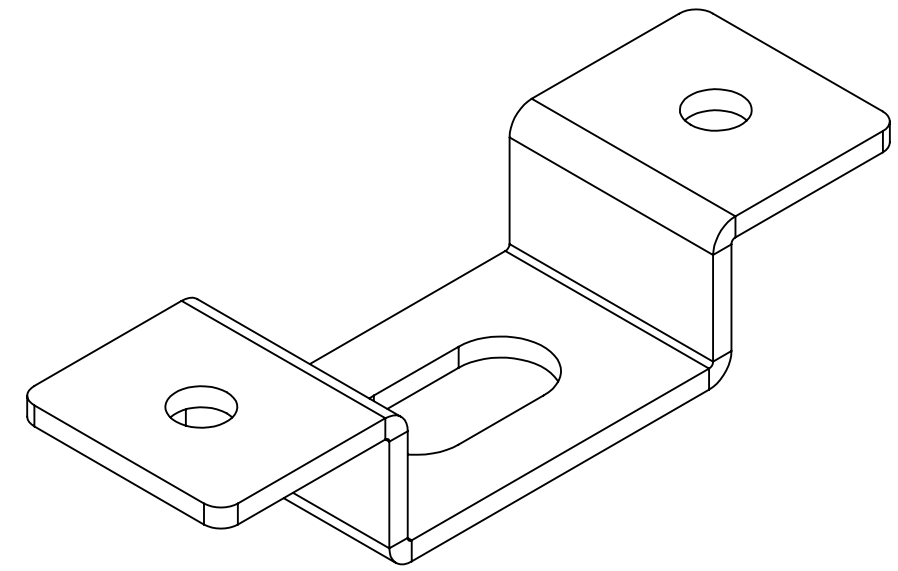
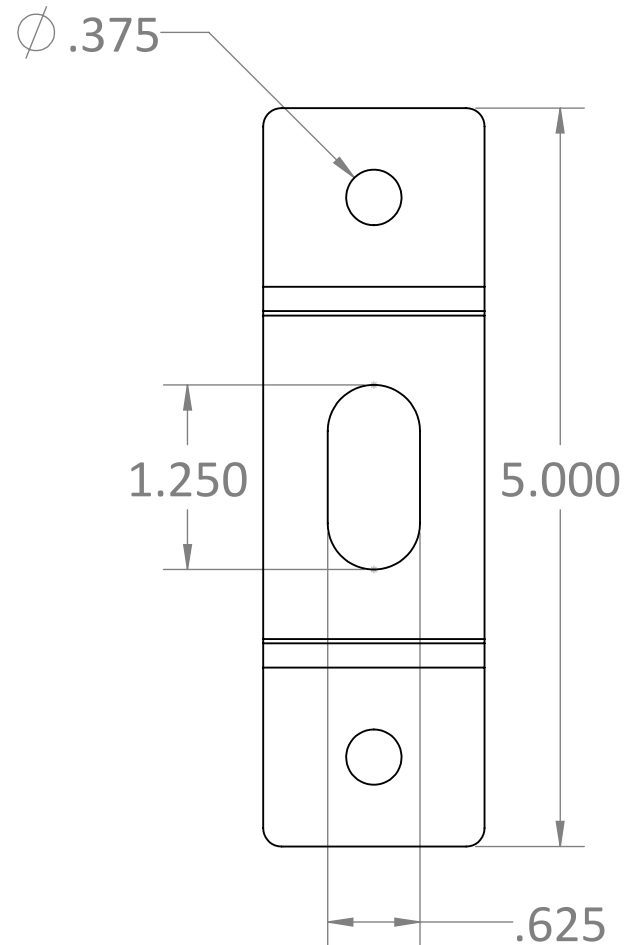

**RXL**  
 PROPRIETARY AND CONFIDENTIAL:  
 THE INFORMATION CONTAINED IN THIS  
 DRAWING IS THE SOLE PROPERTY OF RXL.  
 ANY REPRODUCTION IN PART OR AS A  
 WHOLE WITHOUT THE WRITTEN  
 PERMISSION OF RXL IS PROHIBITED.

SERIES/FAMILY NUMBER:  
**RXL-1019**

DESCRIPTION:  
**1/2in. Slot Ceiling Support Bracket**

REVISION	DATE	REVISION DESCRIPTION:
A	9/23/2020	Initial

CONFIGURATION (SEE TABLE DETAILS/"X" DENOTES COLOR):  
**X12**

COMMENTS/FOLDER PATH:  
 B:\RXL Inc\RXL Engineering - General\RXL\Section 1 - Cable Pathways\RXL-1019 Ceiling Support Brackets\

UNLESS OTHERWISE SPECIFIED: DIMENSIONS ARE IN INCHES TOLERANCES: ±0.03 FRACTIONAL: ±1/32 ANGULAR: ±1° TWO PLACE DECIMAL ±0.03 THREE PLACE DECIMAL ±0.030	MATERIAL: <b>10GA STEEL(0.1345)</b>	FULL PART NUMBER: <b>RXL-1019-X12</b>
	FINISH: <b>PAINT</b>	DRAWN BY: Jackson Chong
	WEIGHT: <b>0.34lbs.</b>	DRAWN DATE: 9/23/2020
SURFACE AREA: <b>20.78in.<sup>2</sup></b>		DO NOT SCALE DRAWING Scale: 1:4
DRAWING SIZE: B SHEET 2 OF 3		

ITEM #	PART NUMBER	CONFIGURATION	DESCRIPTION	MATERIAL	QTY
1	PT-1019-01	X58	Ceiling Hat Bracket, For 5/8 Thread	10GA STEEL(0.1345)	1

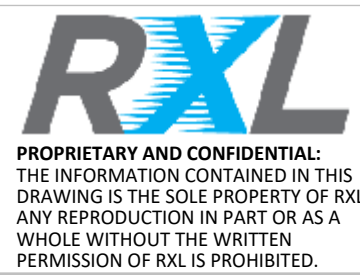
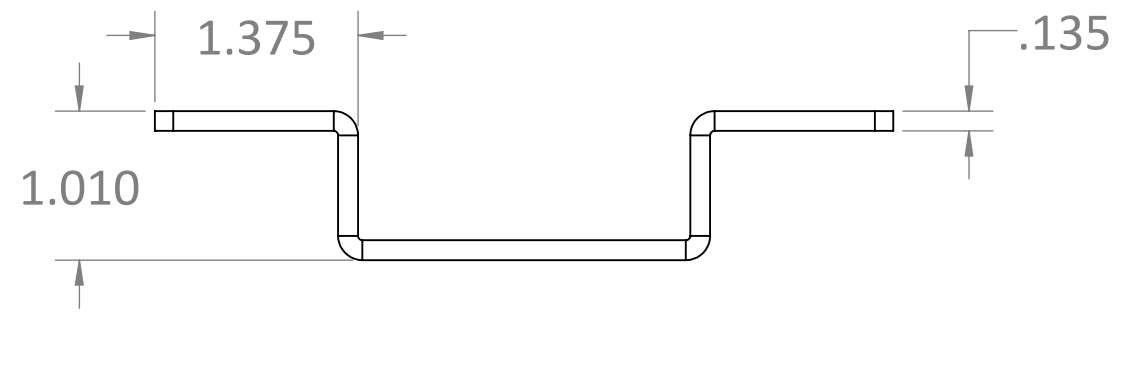
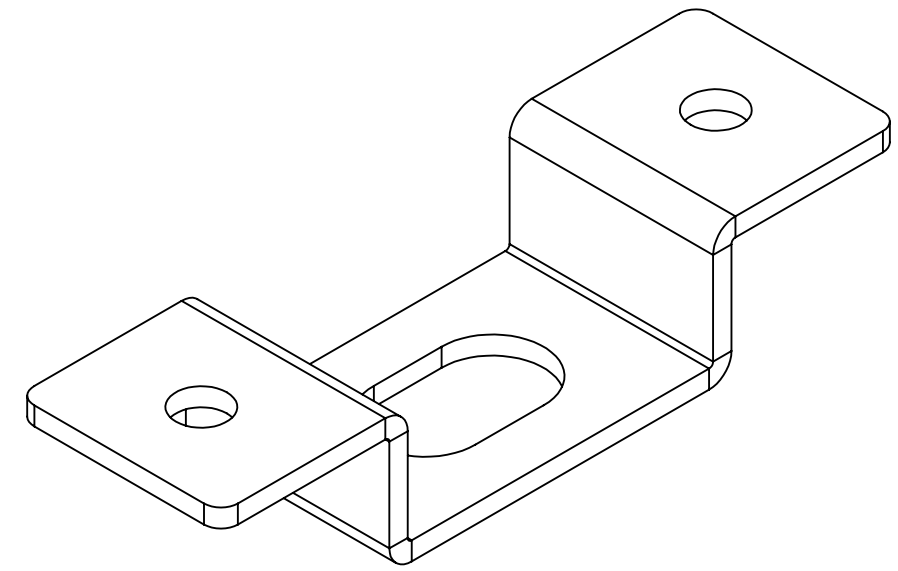
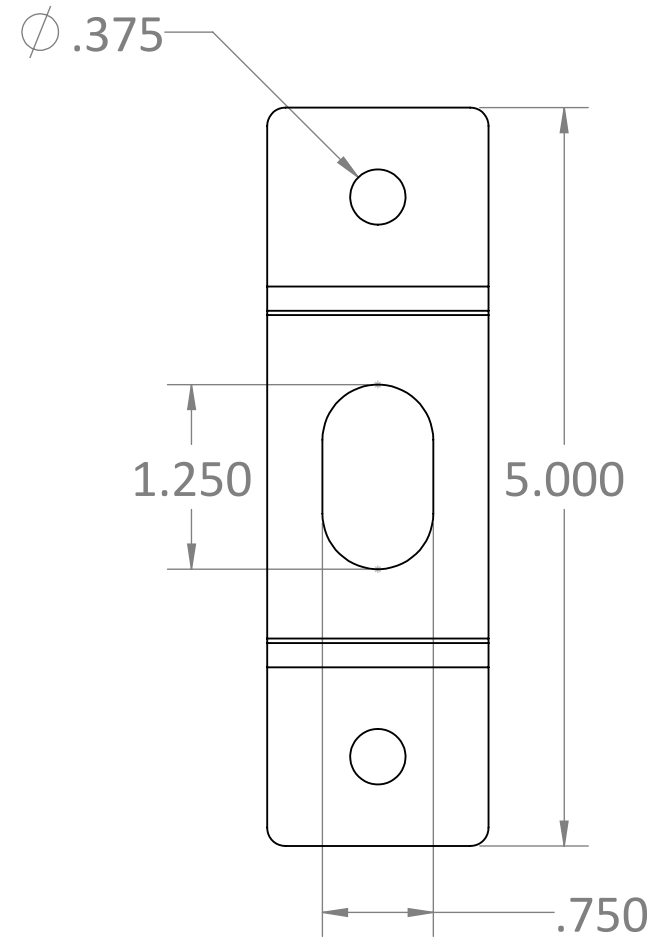

SERIES/FAMILY NUMBER: <b>RXL-1019</b>		CONFIGURATION (SEE TABLE DETAILS/"X" DENOTES COLOR): <b>X58</b>		COMMENTS/FOLDER PATH: B:\RXL Inc\RXL Engineering - General\RXL\Section 1 - Cable Pathways\RXL-1019 Ceiling Support Brackets\	
DESCRIPTION: <b>5/8in. Slot Ceiling Support Bracket</b>				UNLESS OTHERWISE SPECIFIED: DIMENSIONS ARE IN INCHES TOLERANCES: $\pm 0.03$ FRACTIONAL: $\pm 1/32$ ANGULAR: $\pm 1^\circ$ TWO PLACE DECIMAL $\pm 0.03$ THREE PLACE DECIMAL $\pm 0.030$	
REVISION <b>A</b>	DATE <b>9/23/2020</b>	REVISION DESCRIPTION: Initial		MATERIAL: <b>10GA STEEL(0.1345)</b>	FULL PART NUMBER: <b>RXL-1019-X58</b>
				FINISH: <b>PAINT</b>	DRAWN BY: Jackson Chong
				WEIGHT: <b>0.33lbs.</b>	DRAWN DATE: 9/23/2020
				SURFACE AREA: <b>20.56in.<sup>2</sup></b>	DO NOT SCALE DRAWING Scale: 1:4
				DRAWING SIZE: <b>B</b> SHEET 3 OF 3	